

David Chess

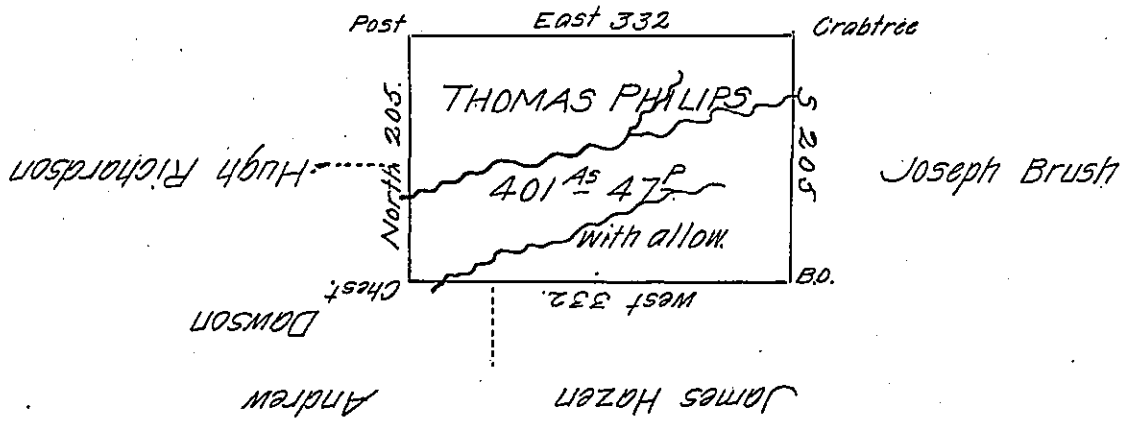

Situate on the waters of Sandy Creek in Sandy Creek Township Mercer County Contain-  
 ing four Hundred and one Acres and forty Seven Parches with allowence of Six percent,  
 for Roads & C. Surveyed April, 1<sup>st</sup> 1803. in pursuence of a Warrant granted to Thomas  
 Philips Dated the Seventh Day of ~~Sept~~ 1800.  
 December

John Findley D.S.

% Saml Cochran Esqr. S.G.

IN TESTIMONY that the above is a copy of the original remaining on file in  
 the Department of Internal Affairs of Pennsylvania, made  
 conformably to an Act of Assembly approved the 16th day of  
 February, 1833, I have hereunto set my Hand and caused  
 the Seal of said Department to be affixed at Harrisburg,  
 this eleventh day of August 1906.

*Geo. P. Brown*  
 Secretary of Internal Affairs.